

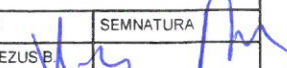

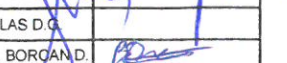





 -ZONA STUDIATA

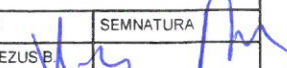
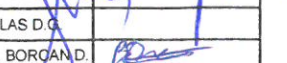

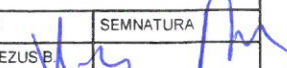
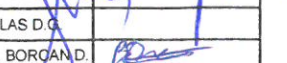
VERIFICATOR/EXPERT	NUME	SEMNATURA	CERINTA	REFERAT Nr./EXPERTIZA Nr.	DATA												
Proiectant general: S.C. MBR CONSTRUCT 2020 S.R.L. mun. RADAUTI, str. CALEA CERNAUTI, nr. 12 jud. SUCEAVA TEL: 0747/110.613 		Beneficiar: S.C. "MILOES RESIDENCE" S.R.L. PRIN SCHIPOR MIHAI mun. RADAUTI, str. VADUL TOPLITEI, nr. 2M, jud. SUCEAVA		FAZA: P.U.Z.													
Proiectant arhitectura: S.C. MBR CONSTRUCT 2020 S.R.L. CUI 43221013 J33/1387/2020		Titlu proiect: INTOCMIRE PUZ PENTRU SCHIMBAREA DESTINATIEI SI REGIMUL DE INALTIME DIN LOCUINTE UNIFAMILIALE TIP P+1E IN LOCUINTE COLECTIVE P+2E SI BRANSAMENTE UTILITATI		SPECIALITATEA: ARHITECTURA Scara: 1:5000 Pr. nr.: 159													
Amplasament: mun. RADAUTI, str. IRACLIE PORUMBESCU, nr. 35, jud. SUCEAVA		Data: sep./2022		Titlu plansa: INCADRARE IN ZONA													
<table border="1"> <thead> <tr> <th>SPECIFICATIE</th> <th>NUME</th> <th>SEMNATURA</th> </tr> </thead> <tbody> <tr> <td>SEF PROIECT</td> <td>ING REZUS B</td> <td></td> </tr> <tr> <td>SEF PROIECT ARHITECTURA</td> <td>ARH. OLAȘ D.C.</td> <td></td> </tr> <tr> <td>DESENAT</td> <td>TEHN. BOROAN D.</td> <td></td> </tr> </tbody> </table>		SPECIFICATIE	NUME	SEMNATURA	SEF PROIECT	ING REZUS B		SEF PROIECT ARHITECTURA	ARH. OLAȘ D.C.		DESENAT	TEHN. BOROAN D.		Plansa: A1			
SPECIFICATIE	NUME	SEMNATURA															
SEF PROIECT	ING REZUS B																
SEF PROIECT ARHITECTURA	ARH. OLAȘ D.C.																
DESENAT	TEHN. BOROAN D.																

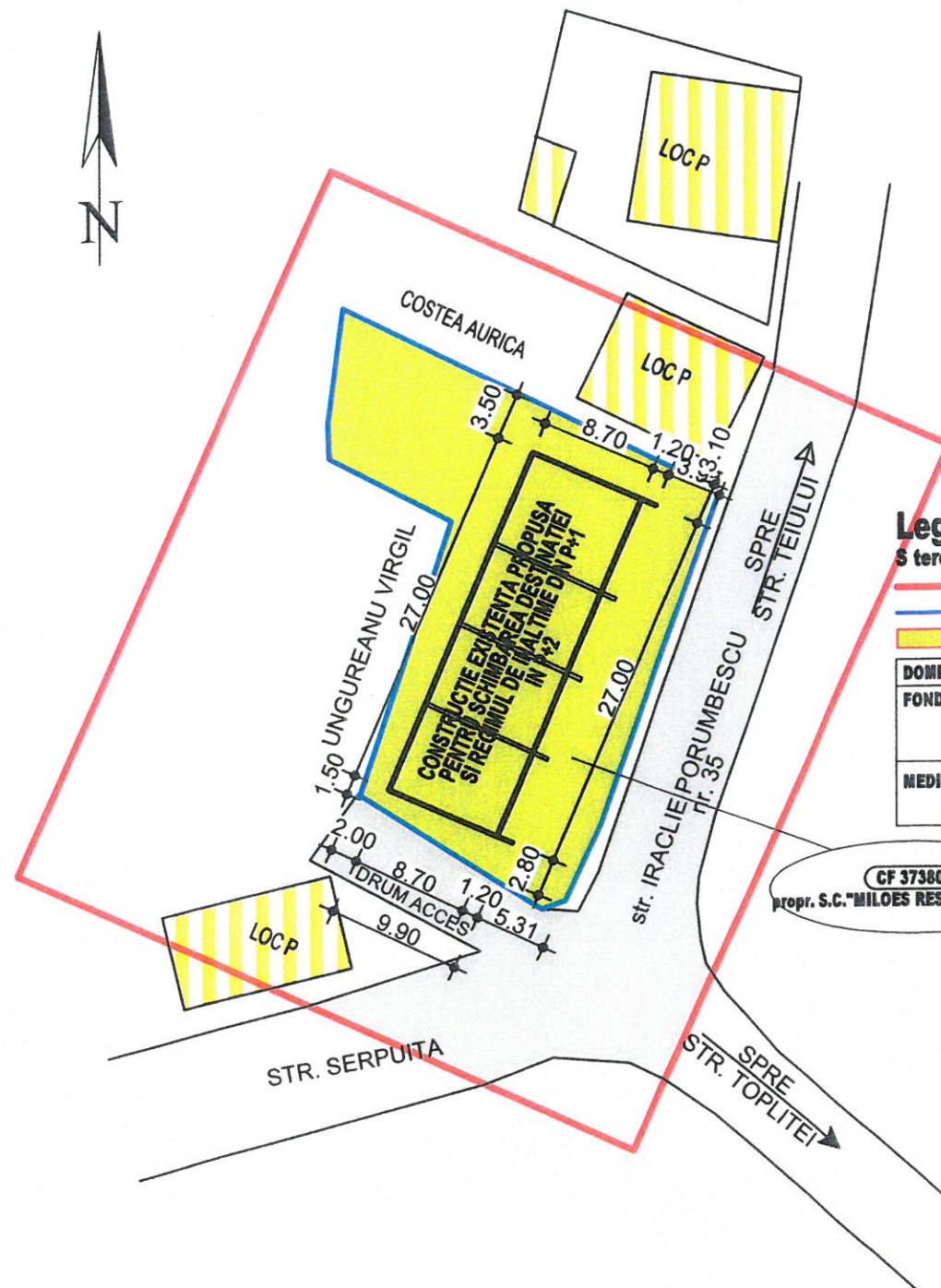

SITUATIE EXISTENTA sc. 1:500

- Legenda:**
 S teren = 688 mp
 - LIMITA PUZ
 - PARCELA STUDIATA
 - CURTI-CONSTRUCTII

DOMENII	DISFUNCTIONALITATI	PROPRIETATI
FOND CONSTRUIT	curti-constructii	schimbarea destinatiei si regimul de inaltime din locuinte unifamiliale tip P+1E in locuinte colective P+2E si bransamente utilitati
MEDIU	nu sunt	obiectivul se va racorda la toate utilitatile (ape-canal, electric, gaze naturale, internet si telefonie)

CF 37380
 propr. S.C. "MILOES RESIDENCE" S.R.L.



VERIFICATOR/EXPERT	NUME	SEMNATURA	CERINTA	REFERAT Nr./EXPERTIZA Nr.	DATA
Proiectant general: S.C. MBR CONSTRUCT 2020 S.R.L. mun. RADAUTI, str. CALEA CERNAUTI, nr. 12 jud. SUCEAVA TEL: 0747/110.613 			Beneficiar: S.C. "MILOES RESIDENCE" S.R.L. PRIN SCHIPOR MIHAI mun. RADAUTI, str. VADUL TOPLITEI, nr. 2M, jud. SUCEAVA		FAZA: P.U.Z.
Proiectant arhitectura: S.C. MBR CONSTRUCT 2020 S.R.L. CUI 43221013 J33/1387/2020			Titlu proiect: INTOCMIRE PUZ PENTRU SCHIMBAREA DESTINATIEI SI REGIMUL DE INALTIME DIN LOCUINTE UNIFAMILIALE TIP P+1E IN LOCUINTE COLECTIVE P+2E SI BRANSAMENTE UTILITATI		SPECIALITATEA: ARHITECTURA Scara: 1:500 Pr. nr.: 159
Amplasament: mun. RADAUTI, str. IRACLIE PORUMBESCU, nr. 35, jud. SUCEAVA		Data: sep./2022		Titlu plansa: SITUATIE EXISTENTA Plansa: A2	
SPECIFICATIE	NUME	SEMNATURA			
SEF PROIECT	ING. REZUS B.				
SEF PROIECT ARHITECTURA	ARH. OLAȘ D.G.				

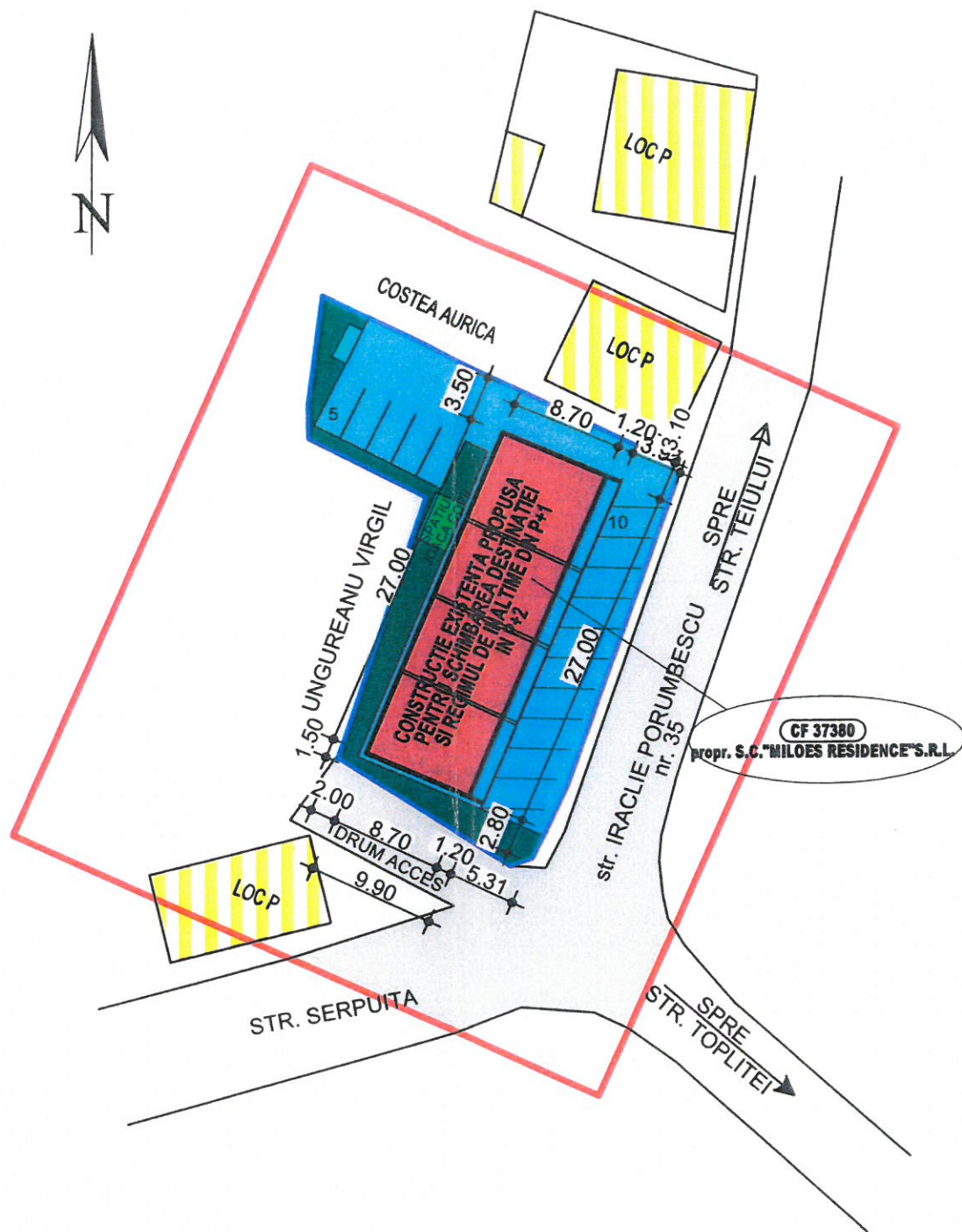

REGLEMENTARI URBANISTICE (zonificare)

Legenda:

- S teren = 688 mp
- LIMITA PUZ
- PARCELA STUDIATA
- CLADIRE PROPU SA SPRE SCHIMBARE DESTINATIE SI REGIMUL DE INALTIME (14 APARTAMENTE)
- ZONA CIRCULATIE SI PARCARE (15 PARCARI)
- ZONA SPATII VERZI
- PLATFORMA GUNOI MENAJER
- SPATIU DE JOACA COPII

Steren= 688 mp; SCexistent= 234.90 mp; SCdexistent= 501.90 mp
SCpropus= 234.90 mp; SCdpropus= 769.20 mp

BILANT TERITORIAL EXISTENT:
P.O.T.= 34.2 % ; C.U.T.= 0.73

BILANT TERITORIAL PROPU S:
P.O.T.= 34.2 % ; C.U.T.= 1.12

P.O.T. MAX = 50% ; C.U.T. MAX = 1.4

GRAD DE REZISTENTA LA FOC- IV
RISC DE INCENDIU = MIC
REGIM DE INALTIME EXISTENT - P+1E
FUNCTIUNEA PROPU SA - SCHIMBAREA DESTINATIEI SI
REGIMUL DE INALTIME DIN LOCUINTE UNIFAMILIALE
TIP P+1E IN LOCUINTE COLECTIVE TIP P+2E SI
BRANSAMENTE UTILITATI
H MAX COAMA= 12.0 m



ZONE FUNCTIONALE	EXISTENTE		PROPUNERE	
	mp	%	mp	%
Zona construita	234.9	34.2	234.9	34.2
Zona circulatie+parcari	190.0	27.6	330.9	48.0
Zona spatii verzi	263.1	38.2	122.2	17.8
TOTAL	688	100	688	100

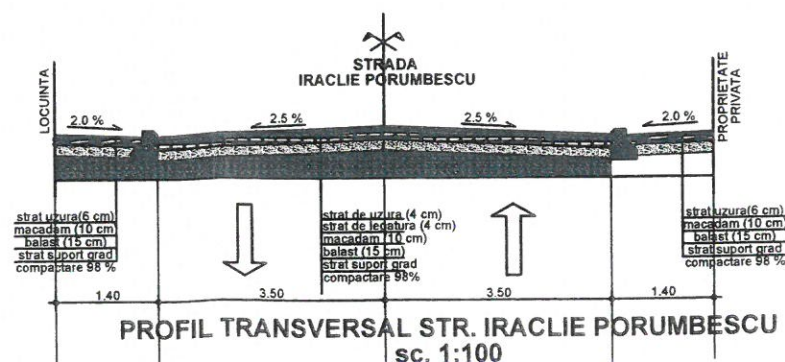

VERIFICATOR/EXPERT	NUME	SEMNETURA	CERINTA	REFERAT Nr./EXPERTIZA Nr.	DATA
Proiectant general:	S.C. MBR CONSTRUCT 2020 S.R.L. mun. RADAUTI, str. CALEA CERNAUTI, nr. 12 jud. SUCEAVA TEL: 0747/110.613		Beneficiar:	S.C. "MILOES RESIDENCE" S.R.L. PRIN SCHIPOR MIHAI mun. RADAUTI, str. VADUL TOPLITEI, nr. 2M, jud. SUCEAVA	FAZA: P.U.Z.
Proiectant arhitectura:	S.C. MBR CONSTRUCT 2020 S.R.L.	CUI 43221013 J33/1387/2020	Titlu proiect:	INTOCMIRE PUZ PENTRU SCHIMBAREA DESTINATIEI SI REGIMUL DE INALTIME DIN LOCUINTE UNIFAMILIALE TIP P+1E IN LOCUINTE COLECTIVE P+2E SI BRANSAMENTE UTILITATI	SPECIALITATEA: ARHITECTURA Scara: 1:500 Pr. nr.: 159
SPECIFICATIE	NUME	SEMNETURA	Amplasament:	mun. RADAUTI, str. IRACLIE PORUMBESCU, nr. 35, jud. SUCEAVA	Data: sep./2022
SEF PROIECT ARHITECTURA	ING. REZUS B.		Titlu plansa:	REGLEMENTARI URBANISTICE ZONIFICARE	Plansa: A3

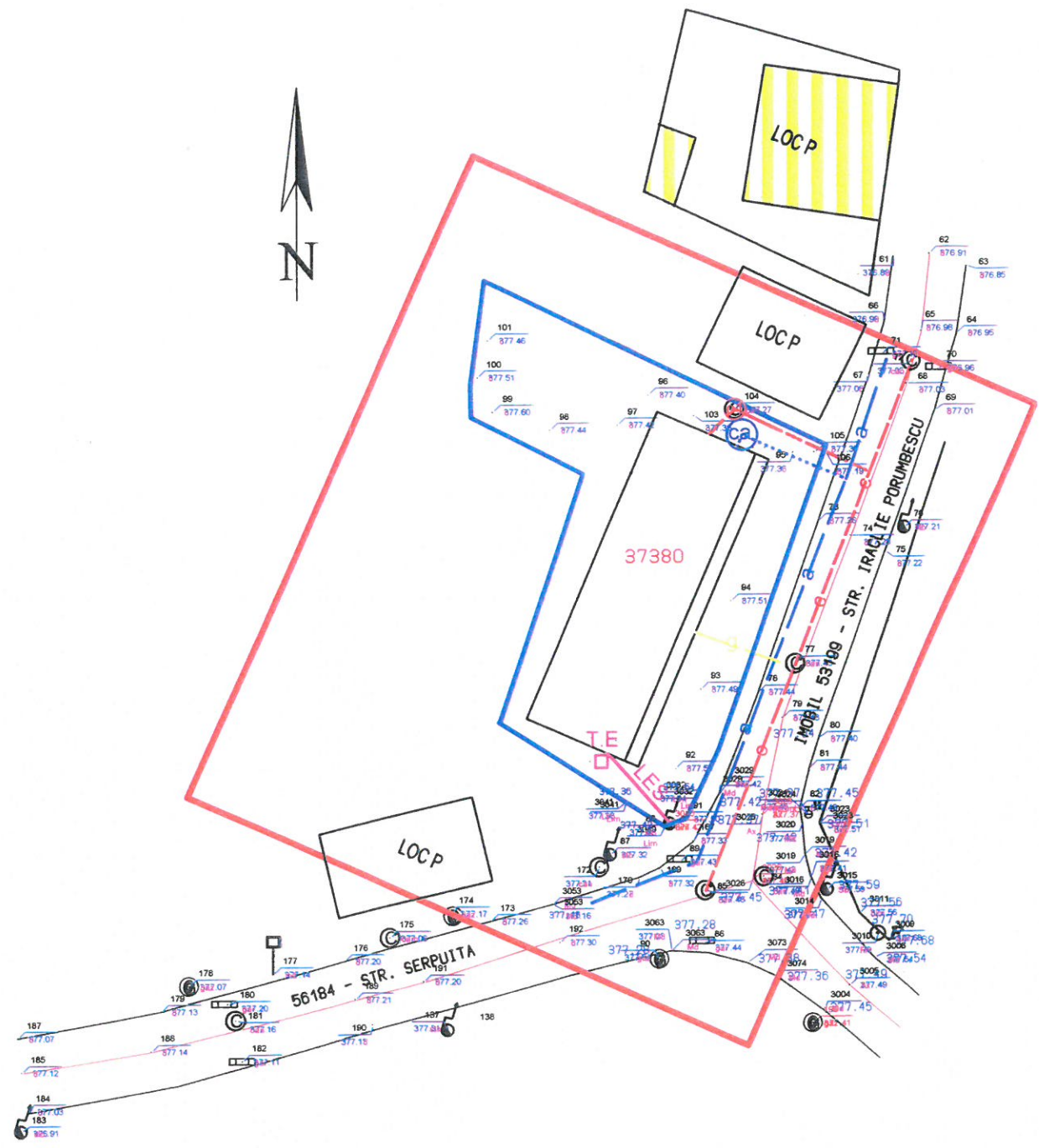













REGLEMENTARI EDILITARE sc. 1:500



LEGENDA:

- ZONA STUDIATA PUZ
- LIMITA PARCELA
- LES - Linie electrica subterana
-  - Stalp electric beton.
- Bransament apa si canal apometru
- Bransament canalizare si camin vizitare
- Retea comunala apa existenta
- Retea canalizare comunala existenta
- TED - Tablou Electric
- Bransament gaz

-LEGENDA-

-  - Margine drum;
-  - Ax Drum;
-  - Limita de proprietate;
-  - Gard de Plasa;
-  - Gard de Lemn;
-  - Camin canal;  - GAZ;
-  - Gura de canal la rigola strazi, cu gratar de scurgere;
-  - Stalp electric beton.
-  - Indicator Rutier;
-  - Fantana;  - Hidrant.

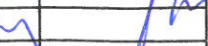

VERIFICATOR/EXPERT	NUME	SEMNATURA	CERINTA	REFERAT Nr./EXPERTIZA Nr.	DATA
Proiectant general: S.C. MBR CONSTRUCT 2020 S.R.L. mun. RADAUTI, str. CALEA CERNAUTI, nr. 12 jud. SUCEAVA TEL: 0747/110.613 		Beneficiar: S.C. "MILOES RESIDENCE" S.R.L. PRIN SCHIPOR MIHAI mun. RADAUTI, str. VADUL TOPLITEI, nr. 2M, jud. SUCEAVA		FAZA: P.U.Z.	
Proiectant arhitectura: S.C. MBR CONSTRUCT 2020 S.R.L. CUI 43221013 J33/1387/2020		Titlu proiect: INTOCMIRE PUZ PENTRU SCHIMBAREA DESTINATIEI SI REGIMUL DE INALTIME DIN LOCUINTE UNIFAMILIALE TIP P+1E IN LOCUINTE COLECTIVE P+2E SI BRANSAMENTE UTILITATI		SPECIALITATEA: ARHITECTURA Scara: 1:500 Pr. nr.: 159	
Amplasament: mun. RADAUTI, str. IRACLIE PORUMBESCU, nr. 35, jud. SUCEAVA		Titlu plansa: REGLEMENTARI EDILITARE		Data: sep./2022 Plansa: A4	
SPECIFICATIE	NUME	SEMNATURA			
SEF PROIECT	ING. REZUS B.				
SEF PROIECT ARHITECTURA	ARH. OLAS D.G.				
DESENAT	TEHN. BORCAN D.				

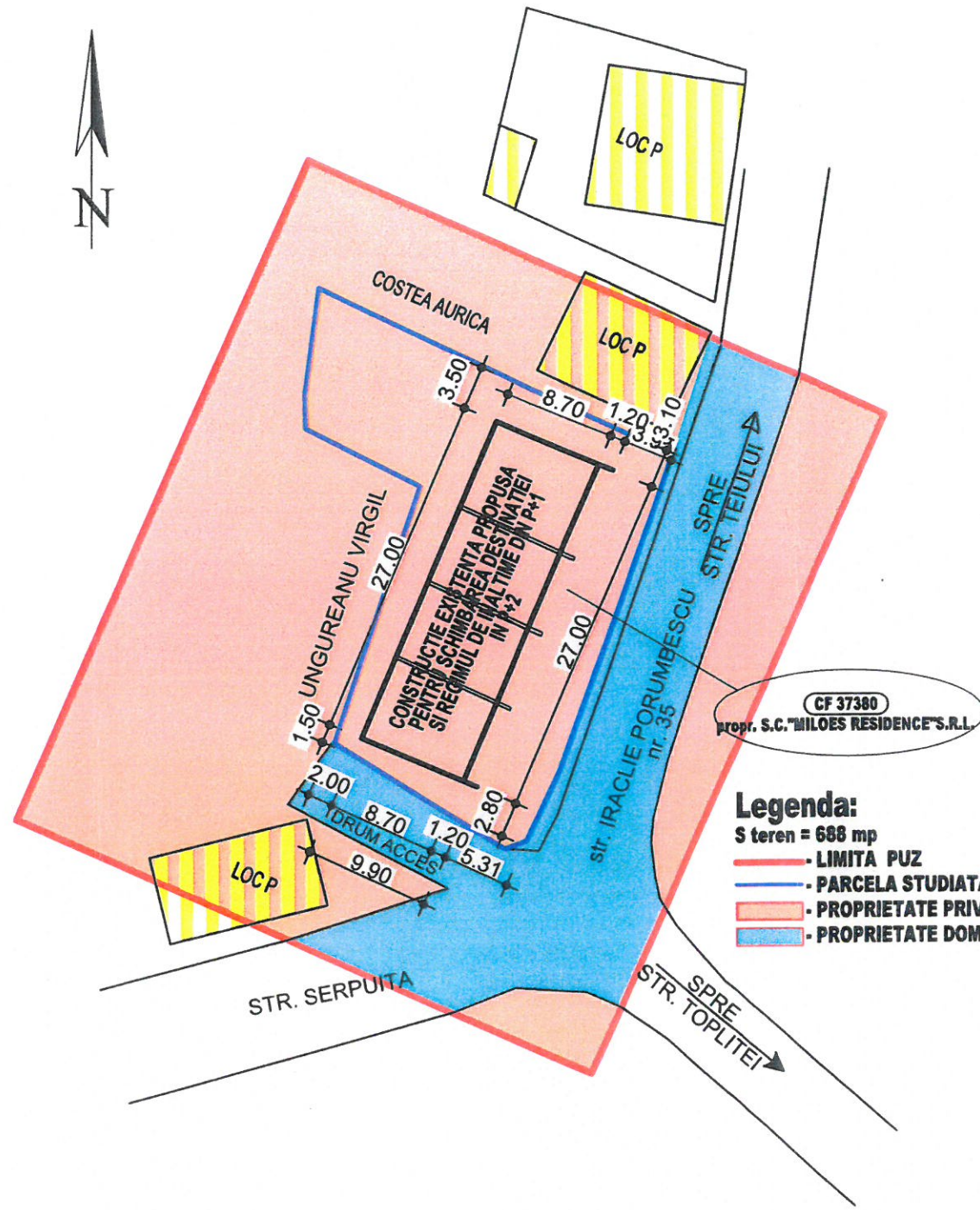

- Legenda:**
 S teren = 688 mp
 - LIMITA PUZ
 - PARCELA STUDIATA
 - PROPRIETATE PRIVATA A PERSOANELOR PUBLICE
 - PROPRIETATE DOMENIU PUBLIC

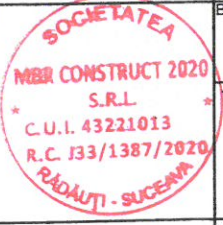

VERIFICATOR/EXPERT	NUME	SEMNATURA	CERINTA	REFERAT Nr./EXPERTIZA Nr.	DATA
Proiectant general: S.C. MBR CONSTRUCT 2020 S.R.L. mun. RADAUTI, str. CALEA CERNAUTI, nr. 12 jud. SUCEAVA TEL: 0747/110.613 				Beneficiar: S.C. "MILOES RESIDENCE" S.R.L. PRIN SCHIPOR MIHAI mun. RADAUTI, str. VADUL TOPLITEI, nr. 2M, jud. SUCEAVA	FAZA: P.U.Z.
Proiectant arhitectura: S.C. MBR CONSTRUCT 2020 S.R.L. CUI 43221013 J33/1387/2020		Amplasament: mun. RADAUTI, str. IRACLIE PORUMBESCU, nr. 35, jud. SUCEAVA		SPECIALITATEA: ARHITECTURA Scara: 1:500 Pr. nr.: 159 Data: sep./2022	
SPECIFICATIE NUME SEMNATURA SEF PROIECT ING REZUS B SEF PROIECT ARHITECTURA ARH OLAȘ D.G. INF SENAT TEHN BORCAN D.		Titlu planșă: PROPRIETATE ASUPRA TERENURI		Planșă: A5	

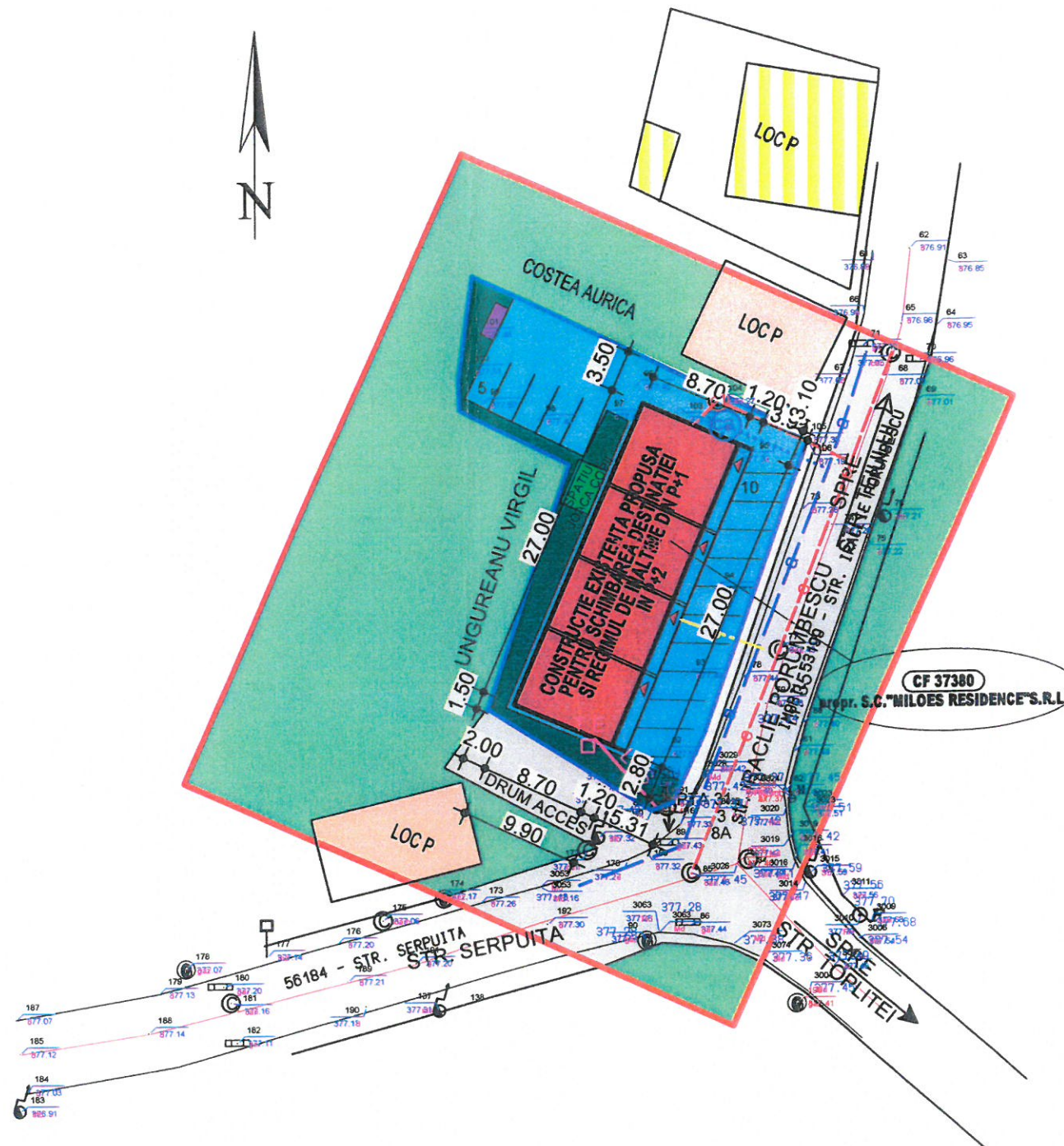

Legenda:

- S teren = 1060 mp
- LIMITA PUZ
 - PARCELA STUDIATA
 - CLADIRE PROPUISA SPRE SCHIMBARE DESTINATIE SI APARTAMENTARE (14 apartamente)
 - ZONA CIRCULATIE SI PARCARE (15 PARCARI-330.9 mp-48.0%)
 - ZONA SPATII VERZI (122.2 mp- 17.8%)
 - CONSTRUCTII EXISTENTE
 - TEREN CURTI-CONSTRUCTII
 - PLATFORMA GUNOI MENAJER
 - ACCES IMOBIL
 - SPATIU DE JOACA COPII
- Linie electrica subterana
 - Stalp electric beton.
 - Bransament apa si canal apometru
 - Bransament canalizare si camin vizitare
 - Retea comunala apa existenta
 - Retea canalizare comunala existenta
 - Tablou Electric
 - Bransament gaz



Steren= 688 mp; SCexistent= 234.90 mp; SCdexistent= 501.90 mp
 SCpropus= 234.90 mp; SCdpropus= 769.20 mp

BILANT TERRITORIAL EXISTENT:
 P.O.T.= 34.2 % ; C.U.T.= 0.73

BILANT TERRITORIAL PROPUIS:
 P.O.T.= 34.2 % ; C.U.T.= 1.12

P.O.T. MAX = 50% ; C.U.T. MAX = 1.4

GRAD DE REZISTENTA LA FOC- IV
RISC DE INCENDIU = MIC
REGIM DE INALTIME EXISTENT - P+1E
FUNCTIUNEA PROPUISA - SCHIMBAREA DESTINATIEI SI
REGIMUL DE INALTIME DIN LOCUINTE UNIFAMILIALE
TIP P+1E IN LOCUINTE COLECTIVE TIP P+2E SI
BRANSAMENTE UTILITATI

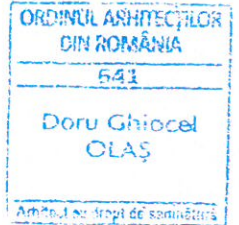

REGLEMENTARI URBANISTICE
 (proponere de mobilare)

VERIFICATOR/EXPERT	NUME	SEMNATURA	CERINTA	REFERAT Nr./EXPERTIZA Nr.	DATA
Proiectant general: S.C. MBR CONSTRUCT 2020 S.R.L. mun. RADAUTI, str. CALEA CERNAUTI, nr. 12 jud. SUCEAVA TEL: 0747/110.613				Beneficiar: S.C. "MILOES RESIDENCE" S.R.L. PRIN SCHIPOR MIHAI mun. RADAUTI, str. VADUL TOPLITEI, nr. 2M, jud. SUCEAVA	FAZA: P.U.Z.
Proiectant arhitectura: S.C. MBR CONSTRUCT 2020 S.R.L.		CUI 43221013 J33/1387/2020		Amplasament: mun. RADAUTI, str. IRACLIE PORUMBESCU, nr. 35, jud. SUCEAVA	SEP./2022
SPECIFICATIE	NUME	SEMNATURA			
SEF PROIECT	ING. REZUS B				
SEF PROIECT ARHITECTURA	ARH. OLAS D.G.				
DEFINAT	TEHN. BURCAN D.				
Titlu proiect: INTOCMIRE PUZ PENTRU SCHIMBAREA DESTINATIEI SI REGIMUL DE INALTIME DIN LOCUINTE UNIFAMILIALE TIP P+1E IN LOCUINTE COLECTIVE P+2E SI BRANSAMENTE UTILITATI				Scara: 1:500	Pr. nr.: 159
Titlu plansa: REGLEMENTARI URBANISTICE PROPUNERE DE MOBILARE				Data: sep./2022	
				Plansa: A6	